

**SAFETY ISOLATING TRANSFORMER**

POWER : 2.3VA  
 INPUT VOLTAGE : 230V  
 FREQUENCY : 50/60Hz  
 NOMINAL OUTPUT VOLTAGE : 24V

INHERENTLY SHORT CIRCUIT PROOF TRANSFORMER  
 IP00  
 UL94V0  
 OPERATING TEMPERATURE : -25°C to 70°C  
 STORAGE TEMPERATURE : -25°C to 85°C  
 INSULATION CLASS (IEC85) : B  
 INHERENT PROTECTION

**STANDARDS :**

- UL506 (File E111078)
- CSA 22-2 (File E111078)
- UL1585 (File E240724)
- VDE (File Ref:1398300)
- EN60950 (File Ref:1398300)
- EN61558-1 (File Ref:1398300)
- EN61558-2-6 (File Ref:1398300)
- CE

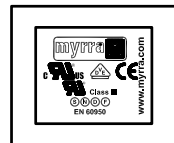
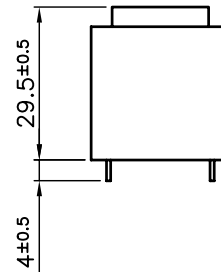
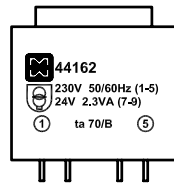

		N°28
--	--	------

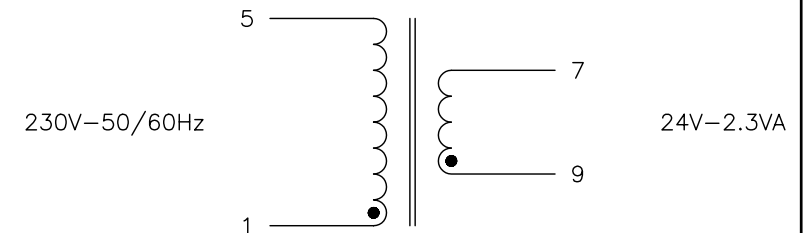

Rev	Date	Modification	Dessiné	Visa

<b>Finition:</b>		<b>Tolérance générale:</b>	
<b>Finition:</b>		<b>General tolerance:</b>	
<b>Ech:</b> 1:1	<b>Matière:</b>	<b>Material:</b>	
<b>Dessiné par:</b> ROUSSEL.Ch	<b>Date:</b> 18/05/2004	<b>Visa:</b>	J.P.M.
<b>DATA SHEET 44162</b>			
<b>EI 30x18</b>			
		22 Allée du Clos des Charmes Z.A. Les Portes de la Forêt 77090 COLLEGIEN Tel : 01-60-37-55-55 Fax : 01-60-17-12-00	
		<b>DS44162</b>	