

Technical data:

Pitch: 2,50 mm  
 Insulating material: High temp. thermoplast UL94V-0  
 Contact material: Copper alloy  
 Rated current: 3 Amp.  
 Rated voltage: 250 V<sub>RMS</sub>/V<sub>DC</sub>  
 Withstanding voltage: min. 1000 V<sub>RMS</sub>  
 Operating temperature: -40°C to +85°C

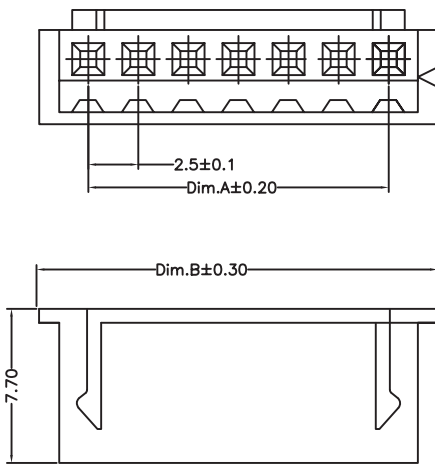

RoHS-compliant

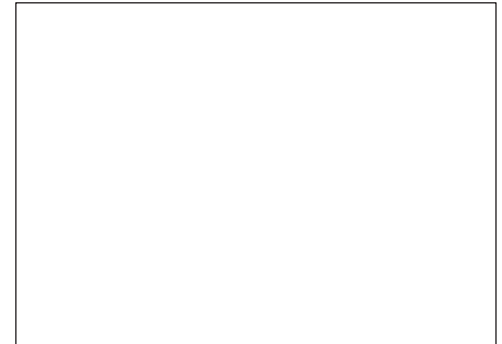

BLC15-0770G-XXXL

XXX = pincount  
 (see table)

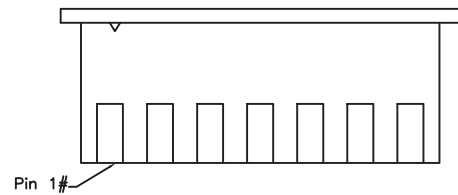
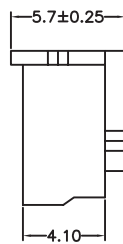

Crimpcontact  
 CC25--22/30-TT-RL  
 Plating: Tin  
 Packsize: 8.000 per Reel

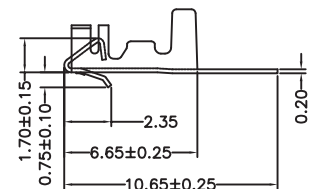
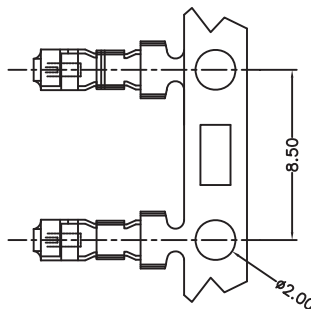

Dimension:

Circuits	DIM:(mm)		Circuits	DIM:(mm)	
	A	B		A	B
002	2.5	7.40	012	27.50	32.40
003	5.00	9.90	013	30.00	34.90
004	7.50	12.40	014	32.50	37.40
005	10.00	14.90	015	35.00	39.90
006	12.50	17.40	016	37.50	42.40
007	15.00	19.90	017	40.00	44.90
008	17.50	22.40	018	42.50	47.40
009	20.00	24.90	019	45.00	49.90
010	22.50	27.40	020	47.50	52.40
011	25.00	29.90			

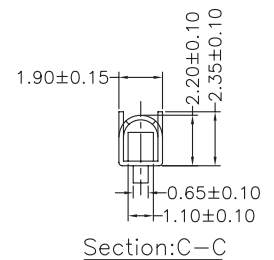
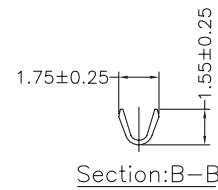
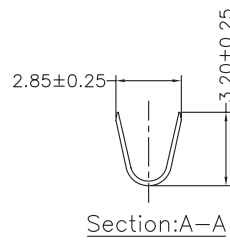

BLC15-0770G-XXXL