

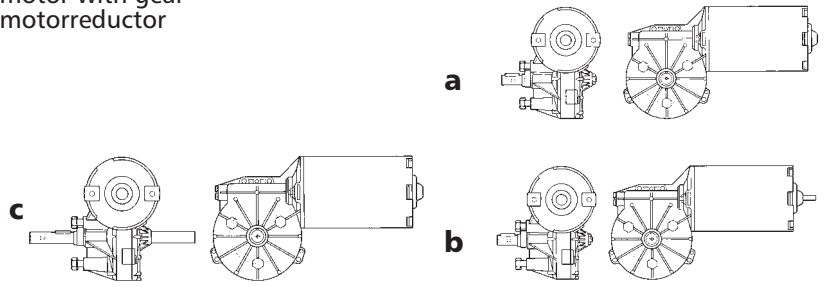

motor with gear motorreductor



| Reference number Referencia | Nominal voltage Tensión nominal | Nominal torque Par nominal | Nominal speed Velocidad nominal | Nominal current Corriente nominal | Starting torque Par de arranque | Starting current Corriente de Arranque | Shaft Eje | Connections Conexiones | Wiring diag. Esq. elect. | Transmission ratio Relación de reducción | Approximate weight Peso aproximado | Watertightness Grado de estanqueidad | Wheel material Material Rueda | Design: a,b,c Diseño: a,b,c | Curve Curva |
|--------------------------------|------------------------------------|-------------------------------|------------------------------------|--------------------------------------|------------------------------------|---|--------------|---------------------------|-----------------------------|---|---------------------------------------|---|----------------------------------|--------------------------------|----------------|
| | Un (V) | Mn (N.m./Lbf.in) | nn (r.p.m.) | In (A) | Ma (N.m./Lbf.in) | Ia (A) | | | | i | P (kg / Lb.t) | IP | | | |
| 259.3710.20.00 | 12 | 20 / 177 | 22 | 12 | 130 / 1150 | 60 | E37 | C34 | EE2 | 50:1 | 5.90/15.80 | IP53 | PLA | a | 20 |
| 259.3710.30.00 | 24 | 20 / 177 | 22 | 6 | 130 / 1150 | 30 | E37 | C34 | EE2 | 50:1 | 5.90/15.80 | IP53 | PLA | a | 20 |
| 259.9001.20.00 | 12 | 15 / 132.7 | 40 | 18 | 120 / 1062 | 98 | E37 | C34 | F2 | 50:1 | 5.90/15.80 | IP53 | PLA | a | 21 |
| 259.9001.30.00 | 24 | 15 / 132.7 | 40 | 9 | 120 / 1062 | 49 | E37 | C34 | F2 | 50:1 | 5.90/15.80 | IP53 | PLA | a | 21 |
| 259.9008.30.00 | 24 | 25 / 221 | 25 | 7 | 135 / 1195 | 30 | E37/E51 | C34 | EE2 | 50:1 | 5.90/15.80 | IP40 | PLA | b | 22 |
| 259.9016.30.00 | 24 | 20 / 177 | 22 | 6 | 130 / 1150 | 30 | E37 | C34 | EE2 | 50:1 | 5.90/15.80 | IP53 | CEL | a | 20 |
| 259.9027.20.00 | 12 | 20 / 177 | 22 | 12 | 130 / 1150 | 60 | E61/E62 | C40 | EE1 | 50:1 | 6.0/16.07 | IP53 | CEL | c | 20 |

DOGA can develop for you on this series a customised version:

DOGA puede desarrollar para usted una versión a medida:

▼

SELF-LOCKING / AUTO-BLOQUEO
BRONZE WHEEL / RUEDA DE BRONCE
RESINBONDED WHEEL / RUEDA DE CELOTEX
FRONT & REAR SHAFT / EJE DELANTERO Y POSTERIOR
HALL SENSOR / SENSOR HALL

▲

and many more / y mucho más
 please contact us / por favor contactenos

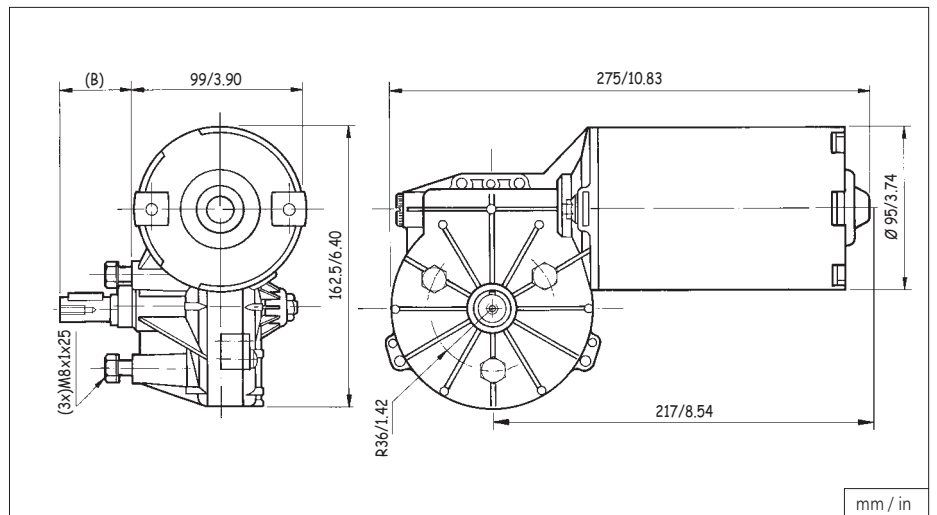

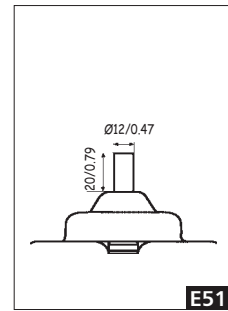
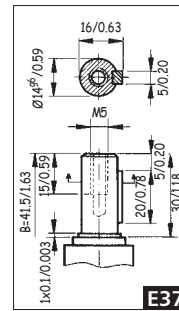
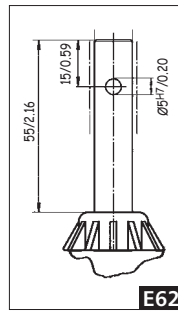
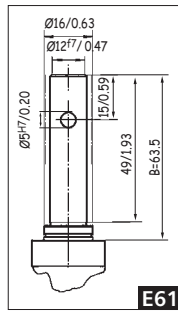

111

CONNECTION - CONEXIÓN

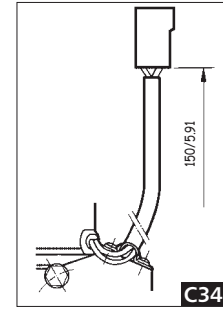
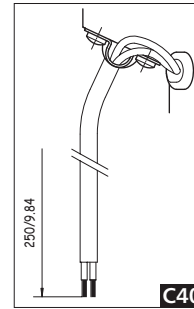

119

210

258

WIRING DIAGRAM - ESQUEMA ELÉCTRICO

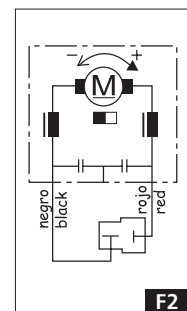
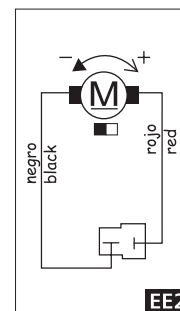
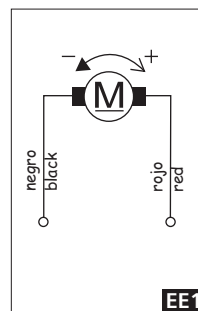

259

316

319

CURVES - CURVAS

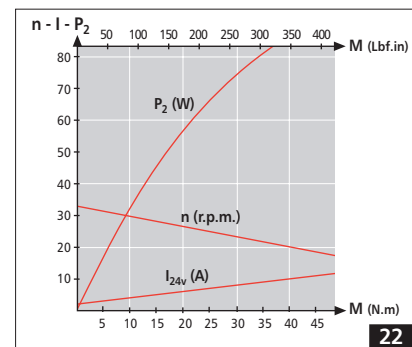
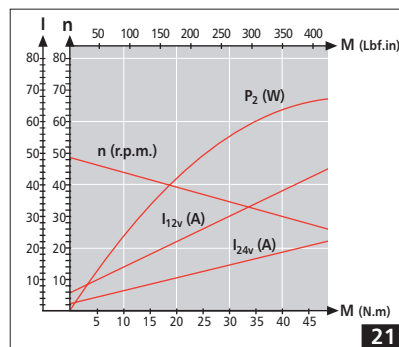
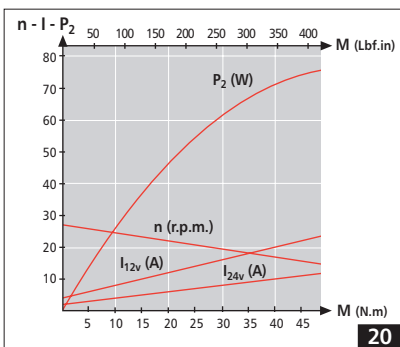

162

168

169

260

269