

Product <b>PASSIVE PFC</b>	Size <b>EI42-20</b>	Type <b>POTTED</b>
Product designation		

## PASSIVE PFC CHOKES - EI42x20 - POTTED

### I MECHANICAL CHARACTERISTICS - PINOUT

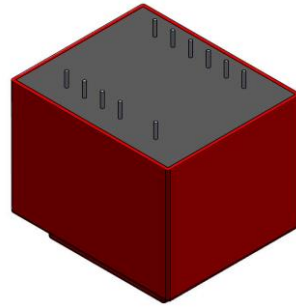
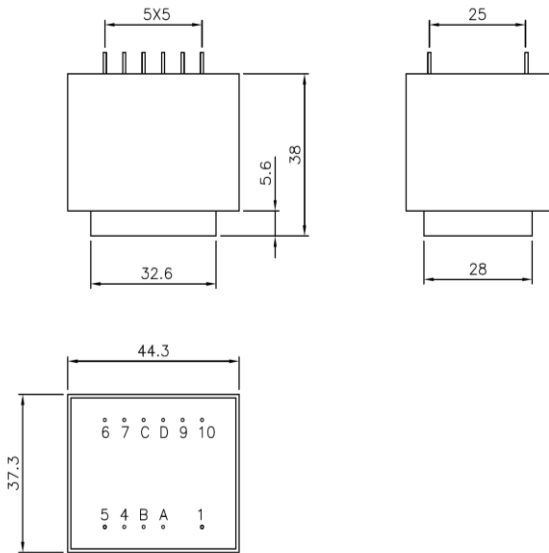

Terminals	
Pins	Ø 0.80 +/- 0.10 mm
PCB recommended drilling diameter	1.3 mm
Pins length	4.0 +/- 0.5 mm
Missing pin	position 2
Tolerances	
General tolerance	+/- 0.5 mm
Pins pitch tolerance	+/- 0.5 mm
Pins row tolerance	+/- 0.5 mm

### II ELECTRICAL CHARACTERISTICS - ENVIRONMENTAL

Typical use at ambient 50, 60 or 70 °C

Reference	Inductance (mH)	Rated current (A <sub>RMS</sub> )	Sat. current (A <sub>pk</sub> )	Temperature class	Type
43310	1.0	5.9	14.0	T70 / B	1
43311	1.5	5.8	13.3	T70 / B	1
43312	2.0	5.2	11.4	T70 / B	1
43313	2.5	4.5	9.4	T70 / B	1
43314	3.0	4.4	8.8	T70 / B	2
43315	3.5	4.4	8.4	T70 / B	2
43316	4.0	4.4	7.8	T60 / B	2
43317	4.5	4.0	7.2	T60 / B	2
43318	5.0	3.9	7.0	T60 / B	2
43319	10.0	2.9	5.2	T60 / B	1
43320	15.0	2.4	4.3	T50 / B	2
43321	20.0	2.0	3.5	T50 / B	2

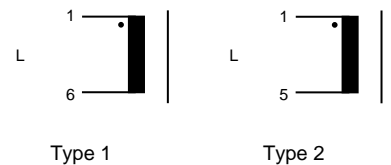

Operating temperature - 40 / + 120 °C  
Storage temperature - 40 / + 85 °C

Rated currents (A<sub>RMS</sub>) will give temperature rising of 40 K for T70, 50 K for T60 and 60 K for T50.

Saturation currents (A<sub>pk</sub>) are stated for a maximum inductance drop of 20%

### III SAFETY - APPROVAL

RoHS and REACH compliant

UL94 V-0 materials

Construction conforms to the certified MYRRA Class B UL Electrical Insulation System E113497-B.

Compliant with IEC61558-2-20