

3000W, 12V- 47V Surface Mount Transient Voltage Suppressor

FEATURES

- AEC-Q101 qualified
- Moisture sensitivity level: level 1, per J-STD-020
- Meets IEC 61000-4-2 (Level: 4) / ISO 10605 (Level: L4)
- Meets ISO 7637-2 (Pulse 1/2a/2b/3a/3b)
- RoHS Compliant
- Halogen-free according to IEC 61249-2-21

APPLICATIONS

- Switching mode power supply (SMPS)
- Motor for BLDC
- Lighting application
- Battery Management System
- Automotive

MECHANICAL DATA

- Case: DO-214AB (SMC)
- Molding compound meets UL 94V-0 flammability rating
- Terminal: Matte tin plated leads, solderable per J-STD-002
- Meet JESD 201 class 2 whisker test
- Polarity: Indicated by cathode band
- Weight: 0.210g (approximately)

KEY PARAMETERS		
PARAMETER	VALUE	UNIT
V_{WM}	10 - 40	V
V_{BR}	12 - 47	V
P_{PPM}	3000	W
T_{JMAX}	175	°C
Polarity	Uni-directional	
Package	DO-214AB (SMC)	



DO-214AB (SMC)



ABSOLUTE MAXIMUM RATINGS ($T_A = 25^\circ\text{C}$ unless otherwise noted)			
PARAMETER	SYMBOL	VALUE	UNIT
Non-repetitive peak impulse power dissipation with 10/1000 μs waveform ⁽¹⁾	P_{PPM}	3000	W
Steady state power dissipation at $T_L = 25^\circ\text{C}$ ⁽²⁾	P_D	8.5	W
Peak forward surge current 8.3ms single half sine-wave	I_{FSM}	300	A
Junction temperature	T_J	-55 to +175	°C
Storage temperature	T_{STG}	-55 to +175	°C

Notes:

1. Non-repetitive current pulse per Fig.3 and derated above $T_A = 25^\circ\text{C}$ per Fig.1
2. Units mounted on PCB (16mm x 16mm Cu pad test board)

THERMAL PERFORMANCE			
PARAMETER	SYMBOL	TYP	UNIT
Junction-to-lead thermal resistance	$R_{\theta JL}$	17	$^{\circ}\text{C}/\text{W}$
Junction-to-ambient thermal resistance	$R_{\theta JA}$	50	$^{\circ}\text{C}/\text{W}$
Junction-to-case thermal resistance	$R_{\theta JC}$	10	$^{\circ}\text{C}/\text{W}$

Thermal Performance Note: Units mounted on PCB (16mm x 16mm Cu pad test board)

ELECTRICAL SPECIFICATIONS ($T_A = 25^{\circ}\text{C}$ unless otherwise noted)											
Part number	Marking code	I_R max at V_{WM}		V_{BR} at $I_T^{(1)}$				V_C at I_{PPM} 10 / 1000 μs		R_D 10 / 1000 μs	$\alpha T^{(2)}$
				Min	Typ	Max	I_T	Max			
		μA	V	V		mA		$\text{V}^{(3)}$	$\text{A}^{(4)}$	Ω	$10^{-4}/^{\circ}\text{C}$
3KSMC12AH	3K12A	5	10	11.4	12.0	12.6	1	17.0	176	0.028	7.8
3KSMC15AH	3K15A	3	13	14.3	15.0	15.8	1	21.5	140	0.046	8.4
3KSMC18AH	3K18A	3	15	16.7	17.6	18.5	1	24.4	123.0	0.055	8.8
3KSMC19AH	3K19A	3	16	17.8	18.7	19.6	1	26.0	115.4	0.063	8.8
3KSMC21AH	3K21A	3	18	20	21.1	22.2	1	29.2	102.7	0.079	9.2
3KSMC23AH	3K23A	3	20	22.2	23.4	24.6	1	32.4	92.6	0.097	9.4
3KSMC26AH	3K26A	3	22	24.4	25.7	27.0	1	35.5	84.5	0.116	9.6
3KSMC28AH	3K28A	3	24	26.7	28.1	29.5	1	38.9	77.1	0.140	9.6
3KSMC30AH	3K30A	3	26	28.9	30.4	31.9	1	42.1	71.3	0.164	9.7
3KSMC33AH	3K33A	3	28	31.1	32.7	34.3	1	45.4	66.1	0.192	9.8
3KSMC35AH	3K35A	3	30	33.3	35.1	36.9	1	48.4	62.0	0.215	9.9
3KSMC39AH	3K39A	3	33	36.7	38.6	40.5	1	53.3	56.3	0.261	10.0
3KSMC42AH	3K42A	3	36	40.0	42.1	44.2	1	58.1	48.4	0.331	10.0
3KSMC47AH	3K47A	3	40	44.4	46.7	49.0	1	64.5	43.5	0.409	10.1

Notes:

- Pulse test: $t_p < 30\text{ms}$
- To calculate V_{BR} or V_C versus junction temperature, use following formulas:
 V_{BR} at $T_J = V_{BR}$ at $25^{\circ}\text{C} \times (1 + \alpha T \times (T_J - 25))$
 V_C at $T_J = V_C$ at $25^{\circ}\text{C} \times (1 + \alpha T \times (T_J - 25))$
- To calculate maximum clamping voltage at other surge level, use the following formula:
 $V_{Cmax} = V_C - R_D \times (I_{PP} - I_{PPappli})$ where $I_{PPappli}$ is the surge current in the application.

ORDERING INFORMATION		
ORDERING CODE	PACKAGE	PACKING
3KSMCxAH	DO-214AB (SMC)	3,000 / Tape & Reel

Notes:

- “x” defines voltage from 12V (3KSMC12AH) to 47V (3KSMC47AH)

CHARACTERISTICS CURVES

($T_A = 25^\circ\text{C}$ unless otherwise noted)

Fig.1 Pulse Power or Current vs. Initial Junction Temperature

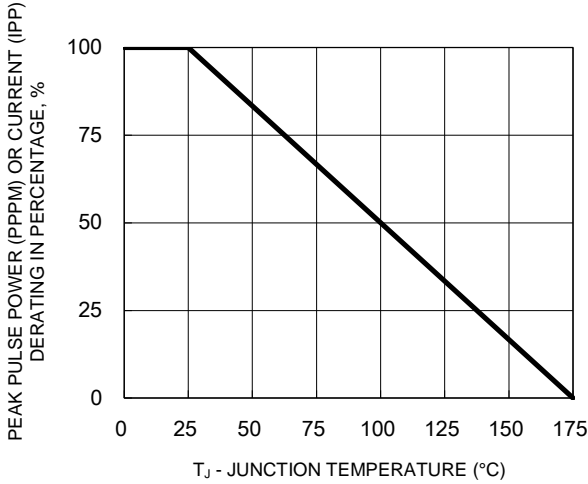

Fig.2 Steady State Power Derating

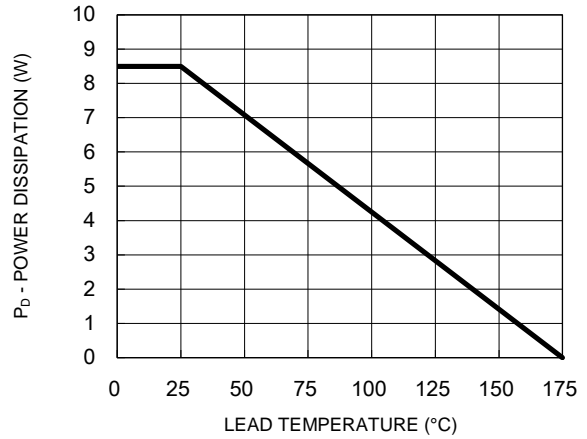

Fig.3 Clamping Power Pulse Waveform

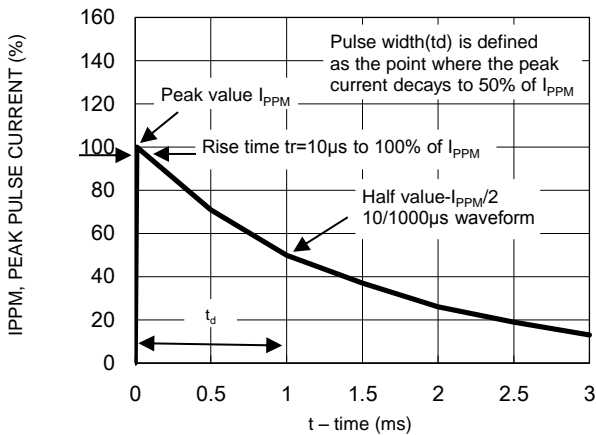

Fig.4 Typical Junction Capacitance

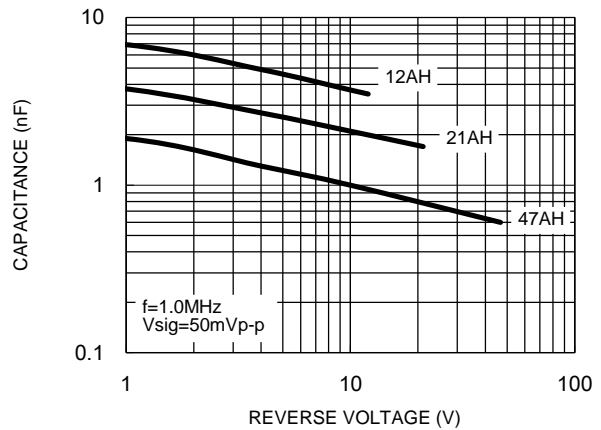

Fig.5 Typical Transient Thermal Impedance

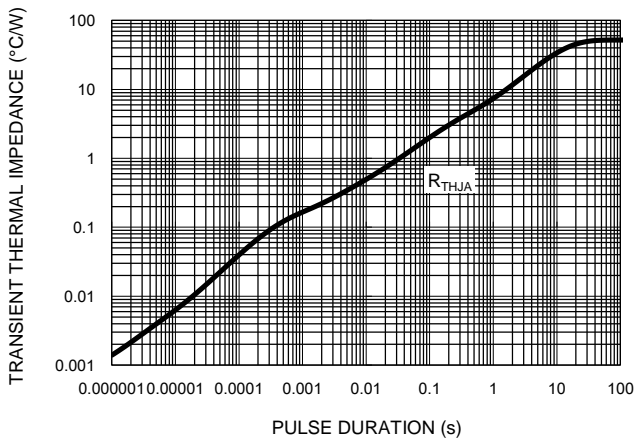
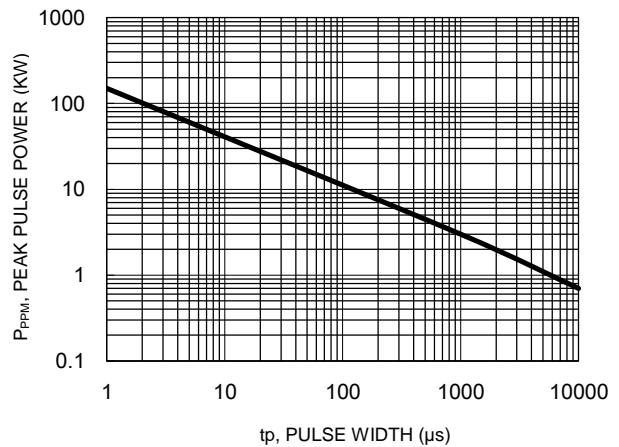
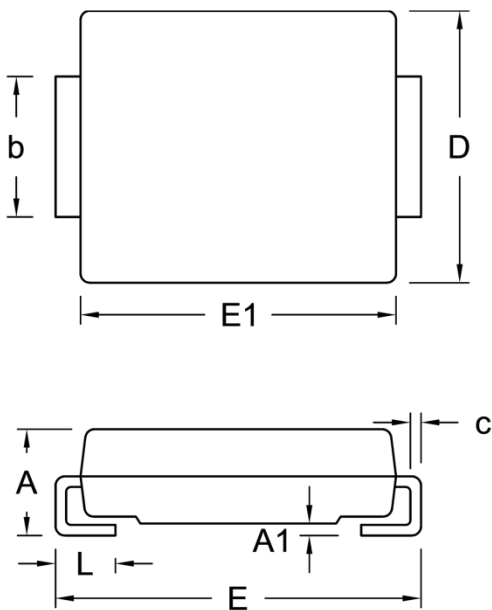

Fig.6 Peak Pulse Power Rating Curve



PACKAGE OUTLINE DIMENSIONS

DO-214AB (SMC)



DIM.	Unit (mm)		Unit (inch)	
	Min.	Max.	Min.	Max.
A	2.00	2.62	0.079	0.103
A1	-	0.20	-	0.008
b	2.90	3.20	0.114	0.126
c	0.15	0.31	0.006	0.012
D	5.59	6.22	0.220	0.245
E	7.75	8.13	0.305	0.320
E1	6.60	7.11	0.260	0.280
L	1.00	1.60	0.039	0.063

SUGGESTED PAD LAYOUT

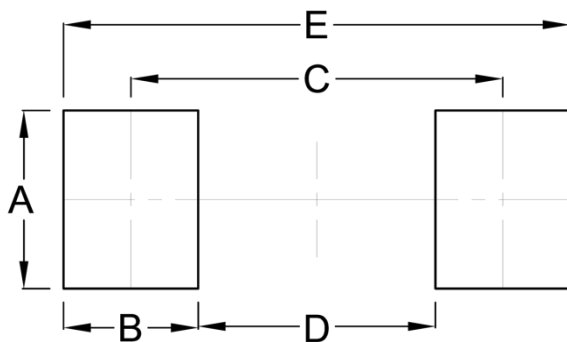

Symbol	Unit (mm)	Unit (inch)
A	3.30	0.130
B	2.50	0.098
C	6.90	0.272
D	4.40	0.173
E	9.40	0.370

MARKING DIAGRAM



- P/N = Marking Code
- G = Green Compound
- YW = Date Code
- F = Factory Code

Notice

Specifications of the products displayed herein are subject to change without notice. TSC or anyone on its behalf, assumes no responsibility or liability for any errors or inaccuracies.

Purchasers are solely responsible for the choice, selection, and use of TSC products and TSC assumes no liability for application assistance or the design of Purchasers' products.

Information contained herein is intended to provide a product description only. No license, express or implied, to any intellectual property rights is granted by this document. Except as provided in TSC's terms and conditions of sale for such products, TSC assumes no liability whatsoever, and disclaims any express or implied warranty, relating to sale and/or use of TSC products including liability or warranties relating to fitness for a particular purpose, merchantability, or infringement of any patent, copyright, or other intellectual property right.

The products shown herein are not designed for use in medical, life-saving, or life-sustaining applications. Customers using or selling these products for use in such applications do so at their own risk and agree to fully indemnify TSC for any damages resulting from such improper use or sale.