

8800 Thinline Rocker Switches 10A 250Vac

rocker switches



- ▶ Ultra thin rocker switch
- ▶ Ratings up to 15A, 250Vac
- ▶ Single and twin gang
- ▶ Panel cut out:
Single 19.3 x 6.8
Twin 19.3 x 13.4

Approvals and specifications



10(6)A 250Vac T100
6(2)A 250Vac T100 5E4 (50,000 Operations)
Inrush 50A to EN60065:1998



UL CSA 15A 250Vac (Twin unit is 10A 250Vac)
UL CSA 125Vac 1/2hp
UL 100°C, file E45221, CSA file LR10990

3mm contact gap.
 Technical data on pages 4 & 5.

H 8800 V A - - -

TERMINAL FUNCTION ROCKER BODY PRINT, COLOUR, ETC

TERMINAL	FUNCTION	ROCKER
<p>H</p> <p>4.8 x 0.8</p>	<p>Switches are ON when pressed over terminal 1</p>	<p>V Curved</p>
<p>8800</p>	<p>ON - OFF Single pole</p>	
<p>T</p> <p>3.5 x 0.8 Solder</p>	<p>Switches are ON when pressed over terminals 1 or 3</p>	
<p>8800/8800</p>	<p>ON - OFF Twin (Single pole)</p>	
<p>X</p> <p>0.8Sq Solder *</p> <p>*Available for single switch only, not twin</p>		



BODY

A Single pole

Panel cut-out Bezel

*Optional profile for orientation

A Single pole - Twin

Panel cut-out Bezel

*Optional profile for orientation

Panel thickness	Dim X
0.75-1.24	19.1/19.2
1.25-1.99	19.3/19.4
2.00-3.00	19.7/19.8

Cut-outs must be punched in the direction of insertion

OPTIONS

Finish
Matt finish only.

Colour
Call sales for custom colours.
A full range is available for large orders.

Legend printing
Select from the examples or call sales for custom legends.

Dimensions (mm)

8800VA (H terminals shown)

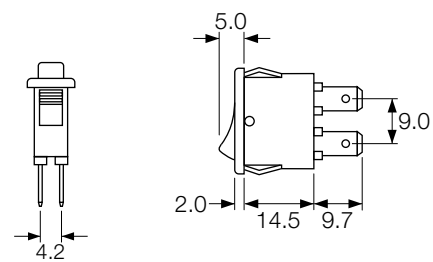

8800V/8800VA (H terminals shown)

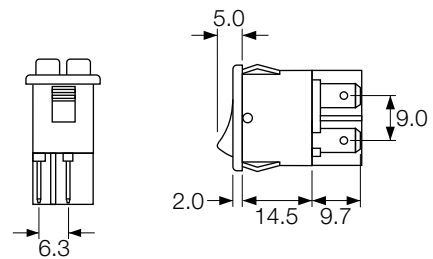

Examples of printing

