

# FEMALE HEADER 1,27 mm

ID: 369

BL 2/15 - 0400XTT

Series 640

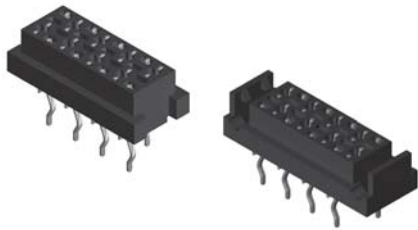

### TECHNICAL DATA

|                               |                                    |
|-------------------------------|------------------------------------|
| Pitch                         | 1,27 mm                            |
| Insulating Material           | high temp. thermoplast UL94V-0     |
| Contact Material              | phosphor bronze                    |
| Rated Current                 | 1 Amp.                             |
| Rated Voltage                 | 230 V <sub>AC/DC</sub>             |
| Withstanding Voltage          | 500 V <sub>AC</sub> for one minute |
| Operating Temperature         | -40°C to +105°C                    |
| Maximum Soldering Temperature | 260°C for 10 seconds               |

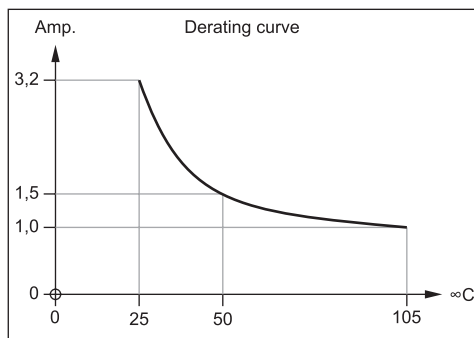
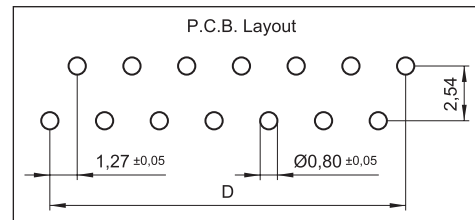
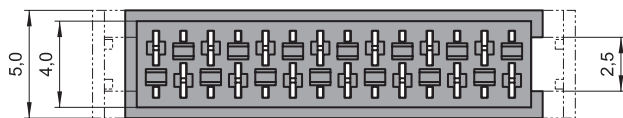
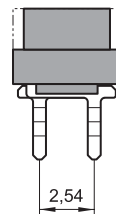
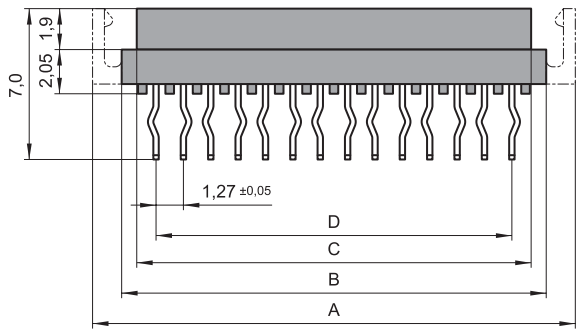

All dimensions in mm.  
Other dimensions upon request.

| No. of contacts | Dimensions |       |       |       |
|-----------------|------------|-------|-------|-------|
|                 | A          | B     | C     | D     |
| 4               | 9,70       | 7,00  | 5,60  | 3,81  |
| 6               | 12,24      | 9,54  | 8,14  | 6,35  |
| 8               | 14,78      | 12,08 | 10,68 | 8,89  |
| 10              | 17,32      | 14,62 | 13,22 | 11,43 |
| 12              | 19,86      | 17,16 | 15,76 | 13,97 |
| 14              | 22,40      | 19,70 | 18,30 | 16,51 |
| 16              | 24,94      | 22,24 | 20,84 | 19,05 |
| 18              | 27,48      | 24,48 | 23,38 | 21,59 |
| 20              | 30,02      | 27,32 | 25,92 | 24,13 |
| 22              | 32,56      | 29,86 | 28,46 | 26,67 |
| 24              | 35,10      | 32,40 | 31,00 | 29,21 |
| 26              | 37,64      | 34,94 | 33,54 | 31,75 |

BL 2/15 - 0400 XX TT - XX R TR U

2/15: 2 rows, pitch 1,27mm

0400: mounting height 4,0mm

XX: G = straight contacts  
GR= straight contacts, with latch

TT: Sn

U: RoHS-compliant with high temp. plastic

TR: Tape&Reel packing (please ask for details before ordering)

R: kinked contacts

Poles: 4 - 26 contacts