

Product <b>PASSIVE PFC</b>	Size <b>EI38-13.6</b>	Type <b>OPEN</b>
Product designation		

## PASSIVE PFC CHOKES - EI38x13.6 - OPEN

### I MECHANICAL CHARACTERISTICS - PINOUT

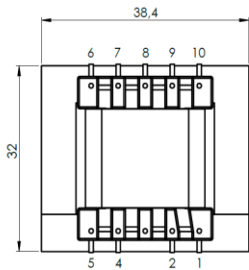
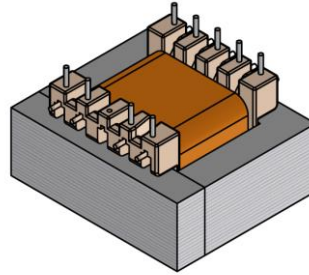
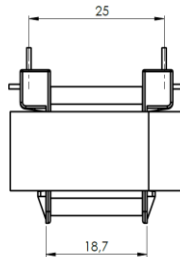
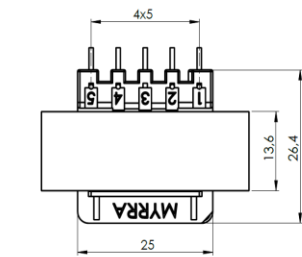

Terminals	
Pins	Ø 0.80 +/- 0.10 mm
PCB recommended drilling diameter	1.3 mm
Pins length	4.0 +/- 0.5 mm
Missing pin	position 3
Tolerances	
General tolerance	+/- 0.5 mm
Pins pitch tolerance	+/- 0.5 mm
Pins row tolerance	+/- 0.5 mm

### II ELECTRICAL CHARACTERISTICS - ENVIRONMENTAL

Typical use at ambient 70 °C

Reference	Inductance (mH)	Rated current (A <sub>RMS</sub> )	Sat. current (A <sub>pk</sub> )	Temperature class	Type
43250	1.0	4.8	10.5	T70 / F	2
43251	1.5	4.7	7.7	T70 / F	1
43252	2.0	4.6	6.4	T70 / F	1
43253	2.5	4.5	6.2	T70 / F	2
43254	3.0	3.6	5.2	T70 / F	2
43255	3.5	3.5	5.1	T70 / F	1
43256	4.0	3.2	5.0	T70 / F	2
43257	4.5	3.1	4.6	T70 / F	2
43258	5.0	2.9	4.0	T70 / F	2
43259	10.0	2.0	2.8	T70 / F	1
43260	15.0	1.5	2.5	T70 / F	2

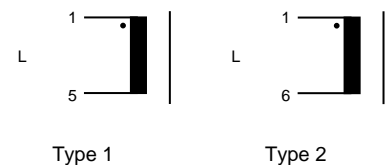

Operating temperature - 40 / + 140 °C  
Storage temperature - 40 / + 85 °C

Rated currents (A<sub>RMS</sub>) will give temperature rising of 60 K.

Saturation currents (A<sub>pk</sub>) are stated for a maximum inductance drop of 20%

### III SAFETY - APPROVAL

RoHS and REACH compliant

UL94 V-0 materials

Construction conforms to the certified MYRRA Class F UL Electrical Insulation System E113497-F5.