

Constant Current LED Power Supply Phasecut Dimmable

SLD15-300IB-Es (for build-in use)
SLD15-300IL-Es (for independent use)



Product description:

This type of power supply is an exclusively designed stabilized power supply for LED lamp. With constant current (CC) technology, it is suitable for constant current lamps (300/350/500/700mA) connected in a series. With optional fittings, it can change from build-in use to independent application. The output current of the converter could be dimmed between 10%-100% by trailing or leading edge dimmers. The built-in protection circuit will shut down the converter in case of such faults as: open circuit, short circuit, over load. The power supply will restart automatically after fault correction.



Standards:

EN61347-1
EN61347-2-13
EN61547
EN55015
EN61000-3-2
EN61000-3-3
EN62384
EN62493

Characteristics:

- Driver for built-in or independent use.
- Dimmable power supply for constant current LED lamp
- Used for lighting equipment in protection class I and II
- The output current of the power supply could be dimmed between 10%-100% by trailing edge or leading edge dimmers
- Open circuit, short circuit, over load protection
- Ripple free
- warranty: 5 years

Specifications:

Model	SLD15-300IB-Es SLD15-300IL-Es	SLD15-350IB-Es SLD15-350IL-Es	SLD15-500IB-Es SLD15-500IL-Es	SLD15-700IB-Es SLD15-700IL-Es	
Output	turn on time(S)	≤0.5	≤0.5	≤0.5	≤0.5
	output current(mA)	300	350	500	700
	output current tolerance ^①	+/-5%	+/-5%	+/-5%	+/-5%
	ripple current(<200hZ)	≤3%	≤3%	≤3%	≤3%
	working voltage range(V)	24-48	24-42	17-30	9-22
	Max. output voltage(V)	60	60	50	35
	dimming interface	Leading or Trailing Edge			
	dimming range	10-100%			
Input	rated supply voltage(Vac)	220-240	220-240	220-240	220-240
	voltage range(Vac)	198-264	198-264	198-264	198-264
	line frequency(Hz)	50/60	50/60	50/60	50/60
	input current(mA)	90	90	90	90
	efficiency ^②	80.8%	80.3%	80.4%	78.9%
	power factor ^②	0.95	0.95	0.95	0.95
	inrush current(Ipk)	2A/17.7us	2A/17.7us	2A/17.7us	2A/17.7us
Protection	over voltage protection	320Vac,1 hour			
	short circuit protection	In case of a short circuit on the secondary side,the ECG will switche off			
	over temperature protection	ECG switches off if the temperature reaches a certain degree			
	automatic restart	ECG works in pulsed light output mode			
	over load protection	After elimination of the fault condition the ECG will recover automatically			
	surge capacity	L-N:0.5KV			
Ambient and Life	Ta(℃)	-25...50			
	Tc max. (℃)	85			
	Storage Temperature(℃)	-30...80			
	ambient humidity range	5%...85%RH, Not condensing			
	nominal life-time(hrs)	50'000@Tc=85 C			
Other	weight(g)	95			
	dimensions (LxWxH)(mm)	85.3x41x22/66.7x41x22			
	casing material	Plastic			
	housing colour	Grey+Blue			
	type of protection	IP20			
	protection class	CLASS II			
Note	<p>1.Tolerance : includes set up tolerance, line regulation and load regulation.</p> <p>2.Tested at full load,230Vac.Refer to"Power Factor" and "EFFICIENT"curve graphs.</p> <p>3.All parameters NOT specially mentioned are measured at nominal voltage input, rated load, 25 of ambient temperature and no dimmer.</p> <p>4.The power supply is considered as a component that will be operated in combination with final equipment. Since EMC performance will be affected by the complete installation, the final equipment manufacturers must re-qualify EMC Directive on the complete installation again.</p>				

Dimensions(mm):

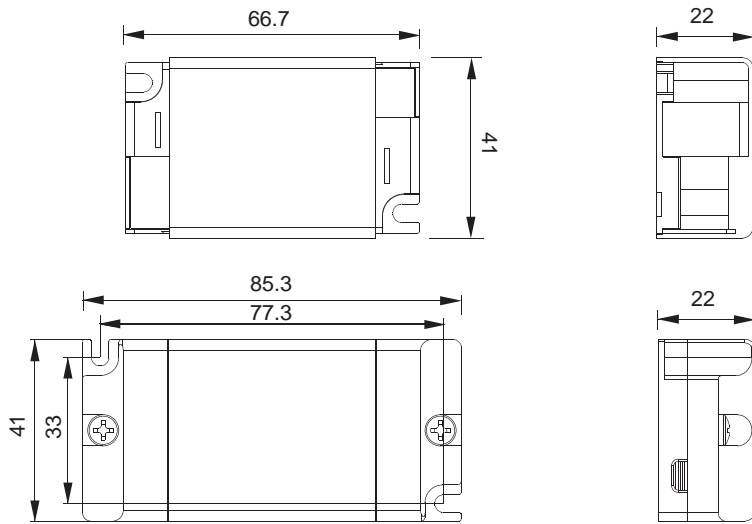

Wiring diagram:

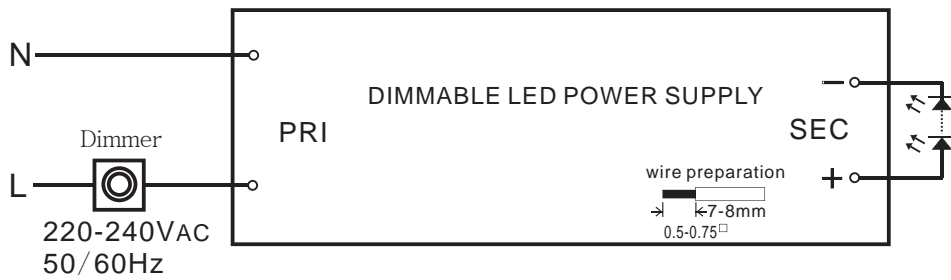

Application:

Built-in application



Independent application

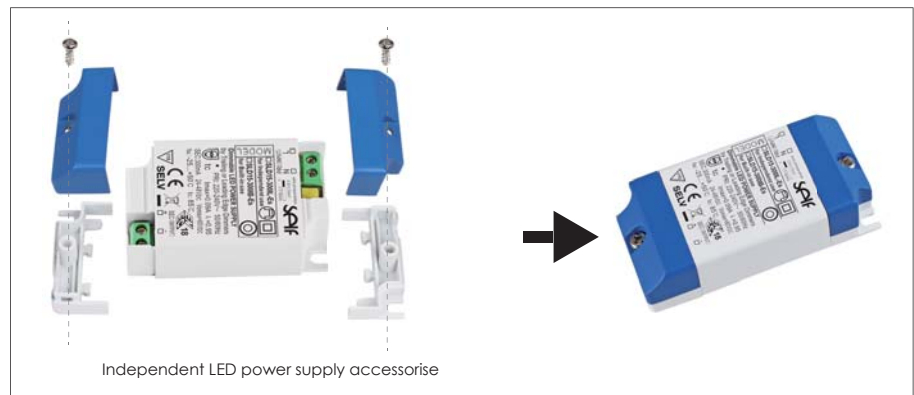

Electrical curves:

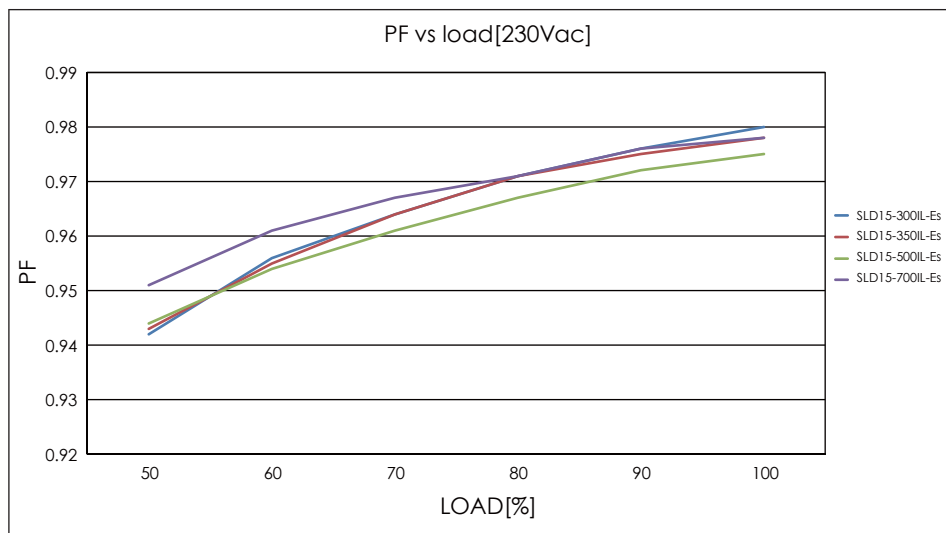
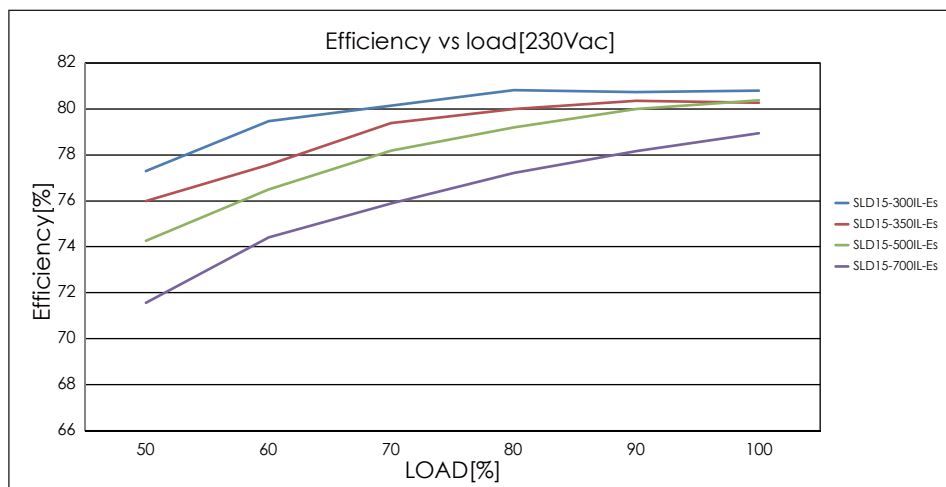

MCBS information:

Miniature circuit breaker Model	Model							
	B10	B13	B16	B20	C10	C13	C16	C20
SLD15-300IB-Es	40	55	70	87	72	87	119	140
SLD15-350IB-Es	40	55	70	87	72	87	119	140
SLD15-500IB-Es	40	55	70	87	72	87	119	140
SLD15-700IB-Es	40	55	70	87	72	87	119	140
SLD15-300IL-Es	40	55	70	87	72	87	119	140
SLD15-350IL-Es	40	55	70	87	72	87	119	140
SLD15-500IL-Es	40	55	70	87	50	65	80	100
SLD15-700IL-Es	40	55	70	87	72	87	119	140

Order information:

Order.No.	Model	Carton quantity(pcs)	Carton dimension(mm)	G.W./CTN(kg)
1001-660296-0130	SLD15-300IB-Es	150	385x275x230	12.8
1001-660298-0130	SLD15-350IB-Es	150	385x275x230	12.8
1001-660295-0130	SLD15-500IB-Es	150	350x295x180	12.8
1001-660303-0130	SLD15-700IB-Es	150	385x275x230	12.8
1001-660299-0130	SLD15-300IL-Es	100	480x230x175	9.4
1001-660294-0130	SLD15-350IL-Es	100	480x230x175	9.9
1001-660293-0131	SLD15-500IL-Es	100	480x230x175	11
1001-660302-0130	SLD15-700IL-Es	100	480x230x175	11

Sales & Technical Support:

SELF Electronics Co.,Ltd.

Add: No. 1345 Ju Xian Road, Ningbo Hi Tech Park, Ningbo, China

Tel: 0086-574-28805765,28805658(For English Assistance)

0086-574-28805678 (For Chinese Assistance)

Fax: 0086-574-28805656

E-mail: sales@self-ecg.com

<http://www.self-ecg.com>

SELF Electronics Co.,Ltd.,Shenzhen Office

Add: Room2007,Xinglang Xuan,Xinghe Mingju,Fuming Road,Futian District,Shenzhen

Tel: 0086-755-83558850, 83558851

Fax: 0086-755-83558840

SELF ELECTRONICS GERMANY GMBH

Add:August-Horch-Str. 7,51149 Koeln

Tel: 0049 2203 18501-0

Fax: 0049 2203 18501-199

E-mail: saleseu@self-electronics.com

*Due to continuous improvements and innovations,specifications are subjected to change without notice.