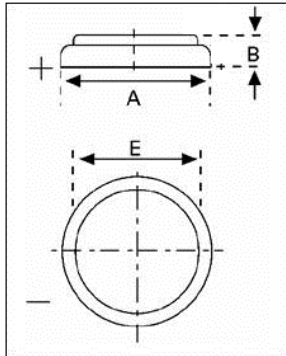

Data Sheet

Type Number	6032
Designation IEC	CR 2032
System	Li-Manganese dioxide / Organic Electrolyte
UL Recognition:	MH 13654
Nominal Voltage	3 V
Typical Capacity C	220 mAh
Load 5.6 kOhm, at 20°C down to 2 V	
Weight (approx.)	3 g
Volume	0,95 ccm
Coding	Date of Manufacturing DWWY

Temperature Ranges	min	max.
Storage	-55°C	70°C
Discharge	-20°C	70°C *

Dimensions	min	max.
Diameter (A)	19,7	20,0
Height (B)	2,9	3,2
Shoulder Diameter (E)	16,0	

Segment Electronic

Main Applications Watches
Digicams
Electronics

Typical Capacities (at 20°C)

Discharge Type	Load	End Voltage:	2.0 V
Continuous 24h/d,7d/w	5600 Ω	Time:	430 h
		Capacity [mAh]:	220
		Energy [mWh]:	610

* Contact VARTA if the application is intended to be outside the range of -20°C to +70°C.

Data Sheet

Performance Data:

• **Temperature Characteristics**

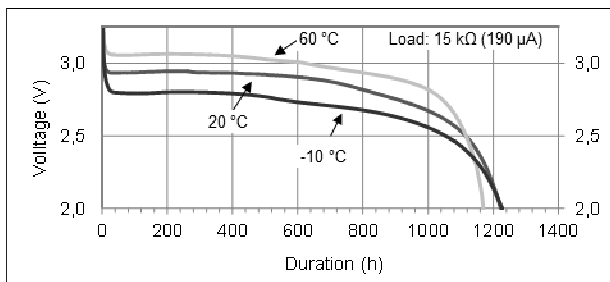

• **Operating Voltage vs. load resistance ***

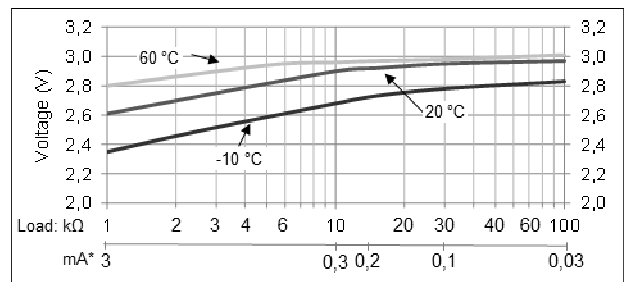

* Voltage at 50% discharge depth

• **Capacity vs. load resistance**

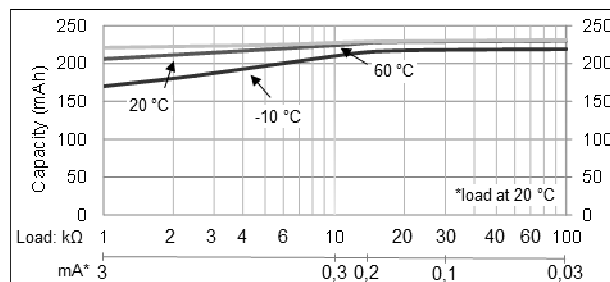

- Self-discharge rate < 1% at room temperature
- Storage life > 10 years
- Operating life* > 10 years

* depending on environmental conditions and energy consumption

All Data contained herein is for single cells

For battery applications, performance data may vary from single cell data, depending on specific battery configuration

VARTA Microbattery GmbH, Daimlerstr. 1, D-73479 Ellwangen/Jagst
Tel.: (+49) 7961/921-0, Telefax: (+49) 7961/921-553

Subject to change without prior notice!
Date of issue: 2013_07_03