

**TOP VIEW**

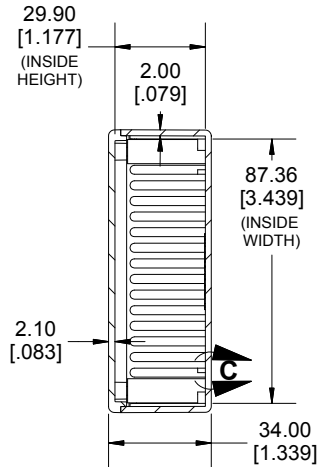

**SECTION A-A**

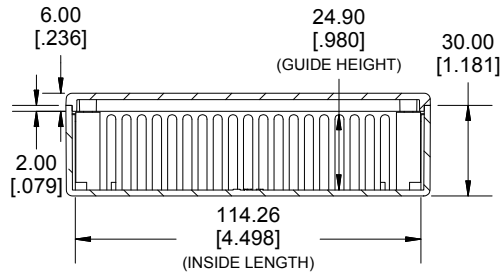
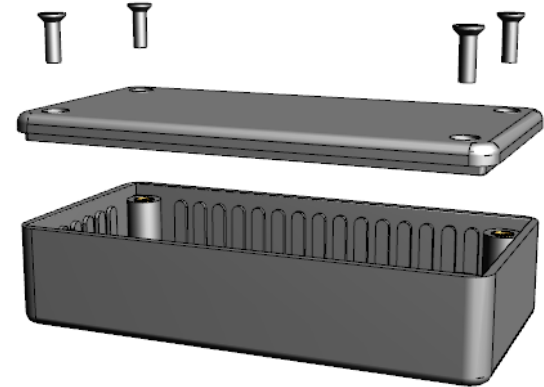

**SECTION B-B  
SIDE VIEW**

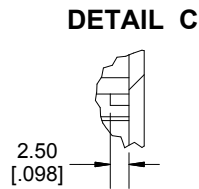

**DETAIL C**

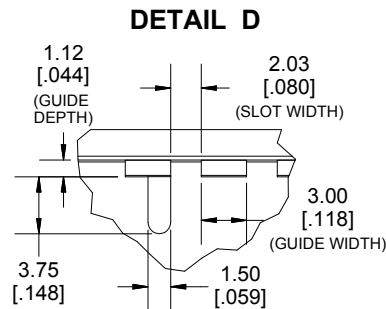

**DETAIL D**

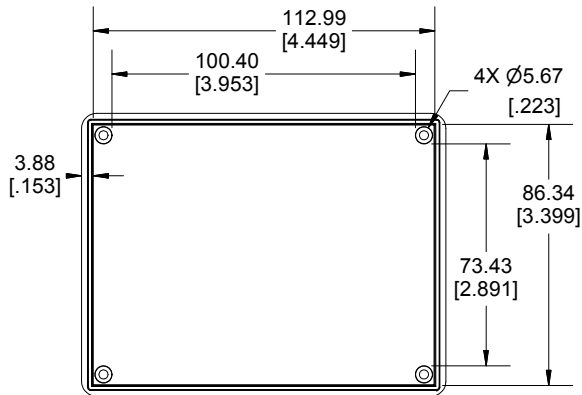

**INSIDE LID**

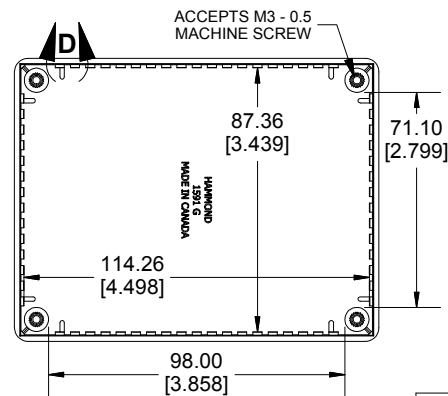

**INSIDE BOX**

Enclosures can be Factory Modified ( Milling, Drilling, Printing etc.)  
Contact Factory [mjm@hammondmfg.com](mailto:mjm@hammondmfg.com) for quotes  
Solid models of this enclosure available in STEP or IGES.

<b>NOTE</b>	
Purchased assembly includes box, lid, 4 cover screws, and pre-installed brass inserts.	
Enclosure made from FRABS or Polycarbonate.	
<b>Recommended Torque: 42-57 ozf.in (30-40 cN.m)</b>	

<b>PART NUMBERS</b>		
<b>1591G Enclosure</b>		
Material	Colour	Part Number
<b>FR ABS UL94 -V0</b>	Beige	1591GBG
	Black	1591GBK
	Blue	1591GBU
	Grey	1591GGY
<b>Accessories</b>		
Plated Cover screw		1591MS100 (Silver)
M3 - 0.5 X 10mm (100Pkg)		1591MS100BK (Black)
PC Board Card Adapters		1591Z6 (6Pkg)
		1591Z50 (50 Pkg)
		1591Z100 (100Pkg)
Nylon Belt / Pocket clip		1599CLIP (Black)
		1599CLIPGY (Grey)
Clear Lids - Flame Retardant Polycarbonate - Lid ONLY		1591GC

**HAMMOND  
MANUFACTURING®**

**1591G**

[www.hammondmfg.com](http://www.hammondmfg.com)

**Dimensions:**  
mm  
[inches]