

# Female Header SMD with Turned Contacts 1,27 mm

Series

**208**

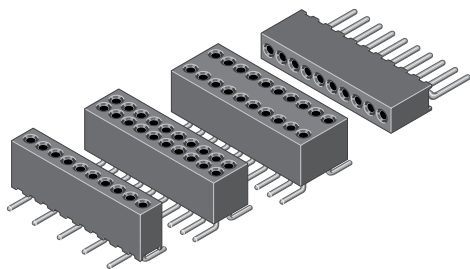

Rated current	1,0 A
Rated voltage	100 V <sub>RMS</sub> / V <sub>DC</sub>
Withstand voltage	500 V <sub>RMS</sub> for one minute
Material contact	Copper alloy
Material clip	Beryllium copper
Material insulator	High temp. thermoplast UL94V-0
Operating temperature	-40°C to +105°C
Max. processing temper.	260°C for 10 seconds

pitch	<b>1,27</b>
termination	
mating pin size	<b>ø 0,38-0,50</b>
max. pincount	<b>050 / 100</b>

All dimensions in mm.

## Variation

### Layout A

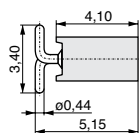
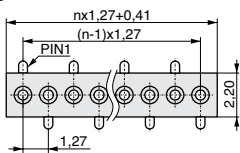

**1**

### Layout B

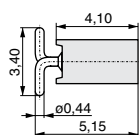
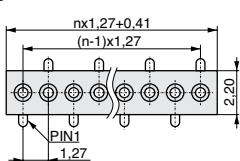

**2**

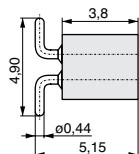
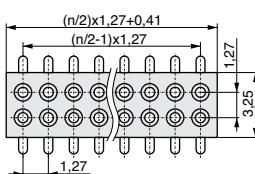

**3**

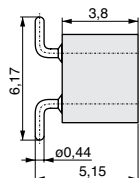
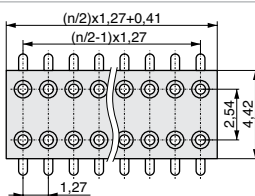

**4**

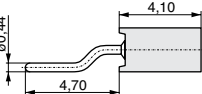
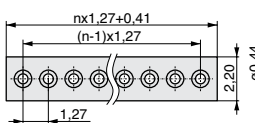

**5**

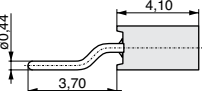
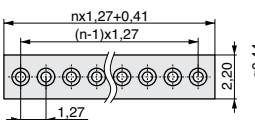

**6**

## PCB Layout

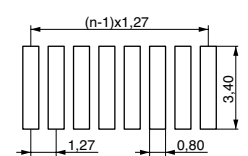
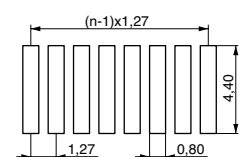
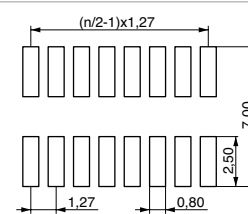
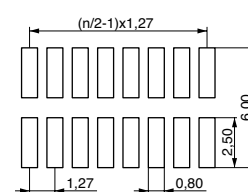
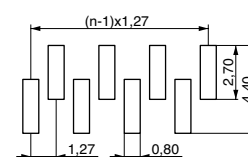
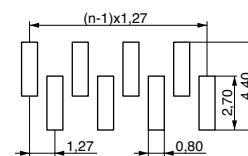

Product group  
**4**

### Clip style:

H = 3 finger clip

### Plating:

T = Sn  
F = Au  
H = Au 0,75 μ

### \* No. of contacts:

Variation 1 = 002 - 050  
Variation 2 = 002 - 050  
Variation 3 = 004 - 100  
Variation 4 = 004 - 100  
Variation 5 = 002 - 050  
Variation 6 = 002 - 050

Variation (1,2,3,...)

No. of contacts \*  
(002,... - 100)

Clip style

Plating contact

Plating clip (F,H)



www.mpe-connector.de

### Order code:

208-?-?-??-0-HT?-LS0

Mating series	188	192	196
see page	3-16	3-17	3-18

CS290312\_V5