

Elektrotechnik Karl-Heinz Mauz GmbH

RMP-14P/FL (Artikel-Nr. 180010SA1)

EKULIT

No.	Technical terms	Value
1	Rated Voltage (Vp-p)	5
2	Max Input Voltage (Vp-p)	30
3	*Rated Current (mA)	≤5
4	Capacitance at 100Hz (pF)	15000±30%
5	*Sound Output at 10cm (dB)	≥80
6	Resonance Frequency (Hz)	4000±500
7	Operating Temperature (°C)	-40~+85
8	Storage Temperature (°C)	-40~+90
9	Weight (g)	0.7
10	Housing Material	PPO
11	RoHS	Yes

*Value applying at rated voltage, 4000Hz, 1/2 duty , square wave

Test basic state: Temp(20±2°C) , Humidity(40~70%RH) , Air pressure(860~1060hPa).

DIMENSIONS (UNIT: mm)

Tolerance: ±0.5mm Except Specified

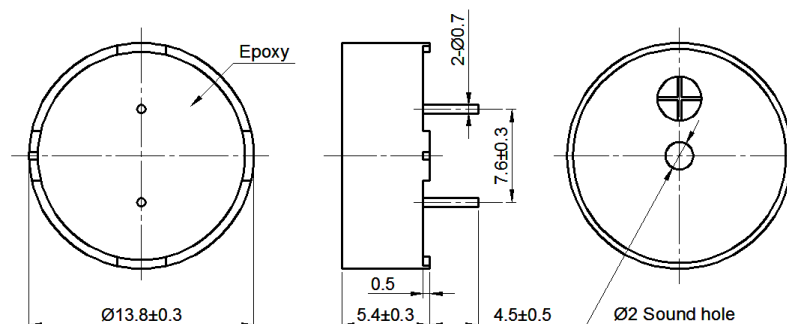

Elektrotechnik Karl-Heinz Mauz GmbH

RMP-14P/FL (Artikel-Nr. 180010SA1)

EKULIT

TEST METHOD:

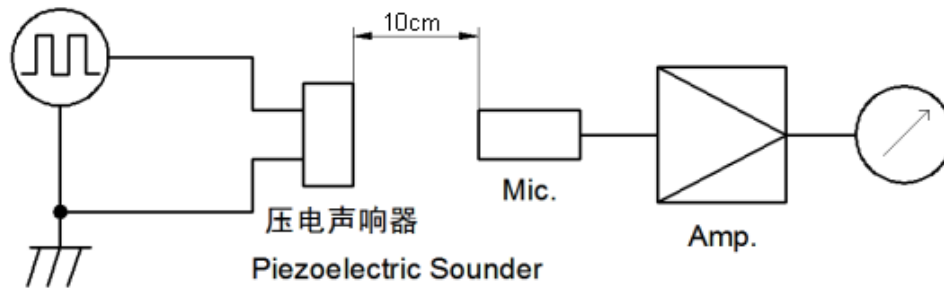

MIC: ND10 普通声级计或等同品
MIC: ND10 Sound Meter or equivalent

信号发生器: DF1641D或等同品
Signal Generator: DF1641D or equivalent

FREQUENCY RESPONSE:

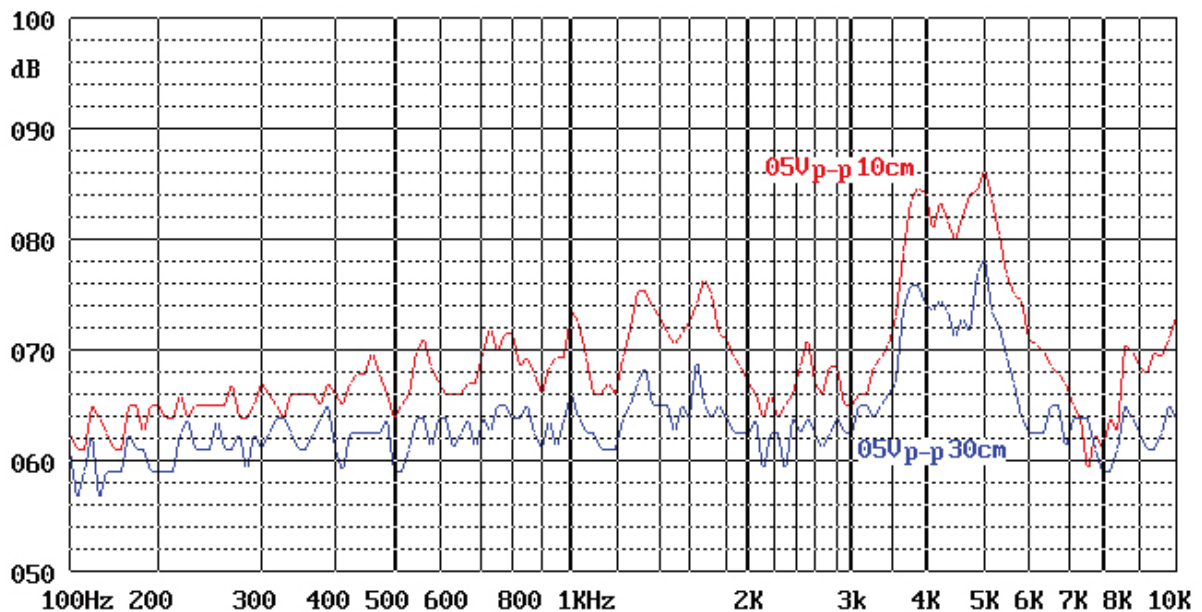



Elektrotechnik Karl-Heinz Mauz GmbH

RMP-14P/FL (Artikel-Nr. 180010SA1)

EKULIT

RELIABILITY TEST:

NO.	ITEM	TESTING CONDITION	VARIANCE AFTER TEST
1	Humidity	40±2°C, 93(+2/-3)%RH, 96HRS	After being placed for 2 to 4hrs at room temperature, part shall be tested. The value of current consumption should be in±10% compared with initial ones. The SPL should be in ±10dB compared with initial one.
2	High temp.	+90±2°C, 96HRS	
3	Low temp.	-40±2°C, 96HRS	
4	Temperature cycling	-40±2°C, 30minutes room temp. 15 minutes +90±2°C, 30 minutes room temp. 15 minutes 5 cycles	
5	Drop test	3 times from height of 70cm onto the surface of 10mm thick wooden board.	
6	Vibration test	Make the test for the directions of X Y and Z (total 0.5 hours). To-and-fro. sweep time (from 10 to 55 Hz and then 55 to 10) under single amplitude of 1.0mm is 1 minute.	
7	Solder heat resistance	The part leads (pins) shall be immersed in molten solder maintained at 260±5°C for a period of 10 seconds. Refer to GB2423.28.	



Elektrotechnik Karl-Heinz Mauz GmbH

RMP-14P/FL (Artikel-Nr. 180010SA1)

EKULIT

PACKING:

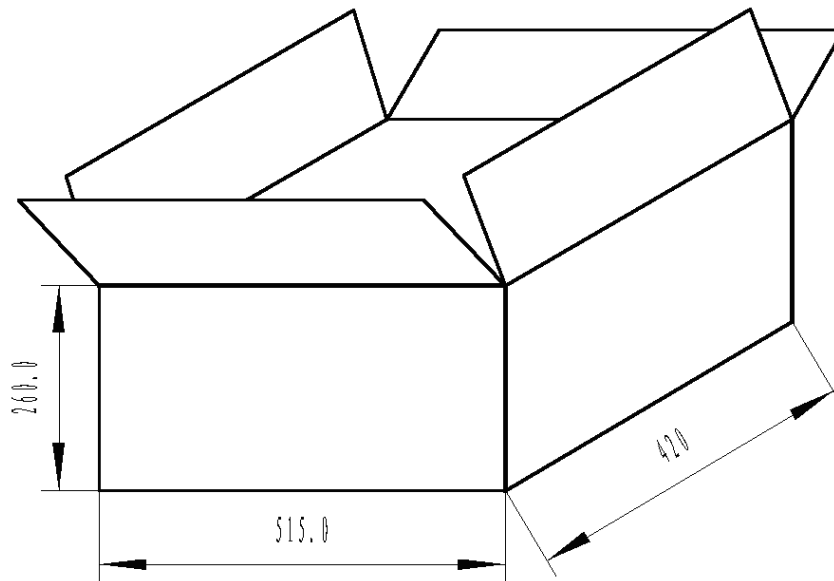

NOTES:

1. 100 PCS per box
2. Total 50 boxes per carton
3. Total 5000 PCS carton
4. Volume: 51.5x42x26cm