



Elektrotechnik Karl-Heinz Mauz GmbH

GM37-520-18315-86-21D (Artikel-Nr. 860532)

EKULIT

SPECIFICATIONS:

Item	Unit	Specification
Rated voltage	VDC	12.0
Gear Ratio		1/86
Rotation		CW
Motor Position		All position in horizontal
Temperature	°C	0~30
Humidity	%	30~95
• Performance of Motor		
No-load Speed	rpm	7.500±10%
No-load Current	mA	55 (max.)
Stall Current	mA	1500 (max.)
Stall Torque	g.cm	190
• Performance of Gear motor		
Output Speed	rpm	85±10%
No-load Current	mA	100 (max.)
Stall Current	mA	1500 (max.)
Stall Torque	kg.cm	14.0
Rated Torque	g.cm	2500
Rated Current	mA	300 (max.)
Noise	dB	52
• The Dimension		
The Outside Shaft Length	mm	21
Shaft End Play	mm	0.05-0.50
Screw Size		M3 (allowed the depth 3mm)
Dia of Shaft	mm	Ø6-D12mm

Adresse: Felix-Wankel-Str. 35 • 73760 Ostfildern/Nellingen

Tel: +49-711/3414023

Fax: +49-711/3414024

E-mail: info@ekulit.de Web site: www.EKULIT.de

Elektrotechnik Karl-Heinz Mauz GmbH

GM37-520-18315-86-21D (Artikel-Nr. 860532)

EKULIT

DIMENSIONS :

(Unit: mm)

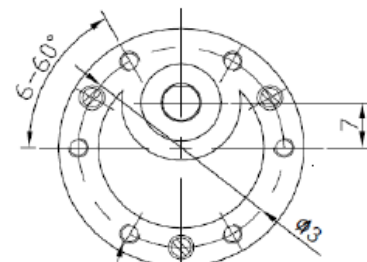
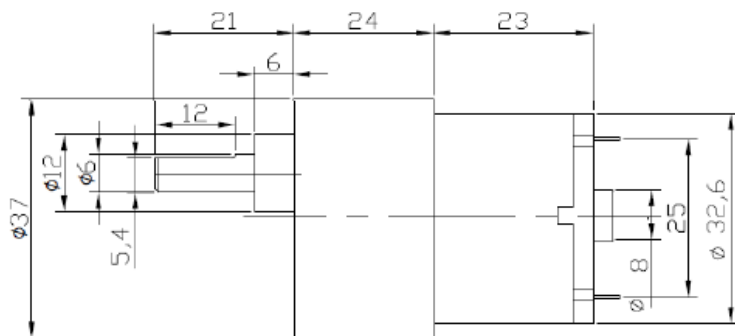

ISO M3:0x3 TAPPED
HOLE 6 PLACES

UNIT: MILLIMETRE(mm)

Curve drawings :

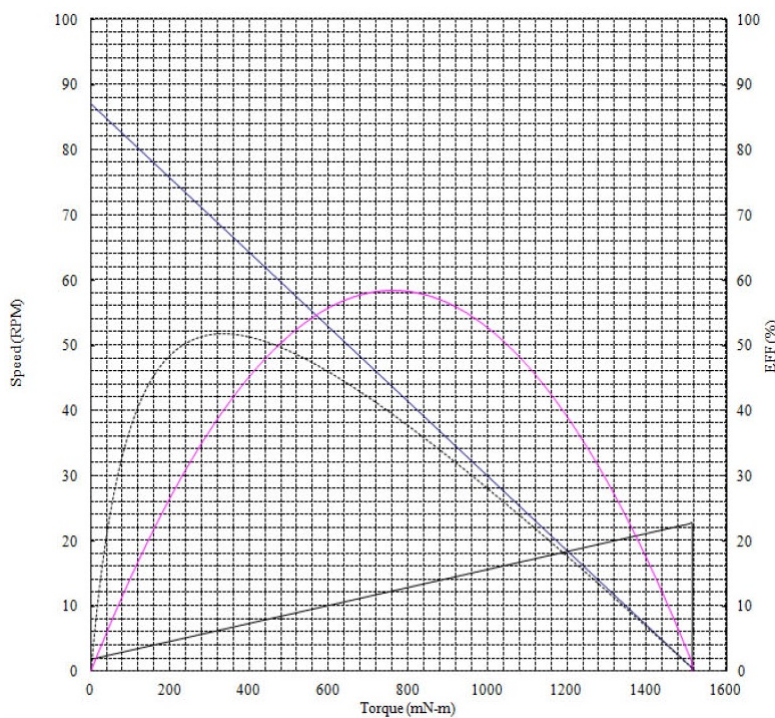

Adresse: Felix-Wankel-Str. 35 • 73760 Ostfildern/Nellingen

Tel: +49-711/3414023

Fax: +49-711/3414024

E-mail: info@ekulit.de Web site: www.EKULIT.de